

Aristo® Tech HD

High Definition 5-13 Welding Helmet

“See the WELD in HD”



The Aristo® Tech HD stands for “High Definition” - with its new matt black shell, newly developed X-Tig feature & optical class 1/1/1/1 represents the “best in class” performance from an auto darkening filter cartridge (ADF).

The newly developed X-Tig feature enhances the ADF's ability to react in low amp applications and almost eliminates sunlight interference and obstructed sensor occurrences

Lens Technology

- Variable 5-13 Digital control for adjustment of shade level, sensitivity and delay
- Optical Class 1/1/1/1
- 100 x 60 mm viewing area
- Grind mode activated at lowest sensitivity
- New “X-TIG” mode - Low amp welding function

Comfort Head Gear

- Ergonomic design head gear
- Instant longitudinal adjustment

Shell

- New matte/carbon black finish
- Conforms to:
- CE, ANSI, AS/NZS, CSA
- EN175-B Impact Shell
- Weight (total helmet) 515g

New “X-TIG” Mode

The newly developed ‘X-TIG’ Functionality gives exceptional performance during low amp welding. Alongside it's two sensors, the Aristo HD has the “X-TIG” electromagnetic arc sensor.

Electromagnetic Arc Sensing eliminates:

- Sunlight interference - Outdoors, Low-Amperage Lens Opening - TIG, Lens Openings - Pipe/Curves, Obstructed Sensors - Hidden/Cavity Welds



Easy view internal LCD screen showing currently set ADF settings - “X-TIG” function, shade level and delay setting

Large viewing area & optimum optical class performance

1/1/1/1



Specifications / Technical Data

Cartridge dimensions	90 x 110 x 7 mm
Viewing Area	100 x 60 mm (viewing area)
Power supply	Solar cells only LCD display model with no battery changes
Sensors	2x traditional Arc sensors & 1x internal magnetic sensor – Helps eliminate: sunlight interference - Outdoors, Low-Amperage Lens Opening - TIG, Lens Openings - Pipe/Curves, Obstructed Sensors - Hidden/Cavity Welds
Classification	1/1/1/1
Protection for ADF	Reflection free front cover lens + inside cover lens
Application ranges	All electric arc welding processes - Electrode Welding (Stick Welding, SMAW) / MIG / MAG (GMAW) / GMAW High melting rate process / Flux Cored Wire Welding / TIG > 5 amps welding (GTAW) / Plasma Arc Welding
Standards	CE, DIN, ANSI, CSA, AS/NZS

Ordering Information – Spares for Aristo® Tech HD

Aristo Tech HD Carbon Internal 5-13 Helmet	0700 000 450
1 Helmet shell Aristo® Tech HD Carbon Black	0700 000 453
* Aristo® Tech HD Headgear side bolts	0700 000 459
* Aristo® Tech HD Headgear	0700 000 454
* Sweat band Aristo® Tech & Aristo® Tech HD, pack of 2	0700 000 369
2 Front cover lens – Aristo® Tech HD/Eye-Tech, Warrior Tech™ pack of 10	0700 000 010
2 Front cover lens Hard Coated – Aristo® Tech HD/Eye-Tech, Warrior Tech™ pack of 10	0700 000 370
3 Inside cover lens Aristo® Tech HD, pack of 5	0700 000 455
4 Cartridge 5-13 Aristo® HD	0700 000 456
5 Potentiometer Aristo® Tech & Aristo® Tech HD	0700 000 373
6 Magnifying lens +1,0 dioptr	0700 000 084
6 Magnifying lens +1,5 dioptr	0700 000 085
6 Magnifying lens +2,0 dioptr	0700 000 086
6 Magnifying lens +2,5 dioptr	0700 000 087
* Leather chest protector for welding helmet	0700 000 062
* Leather head and chest protector for welding helmet	0700 000 063

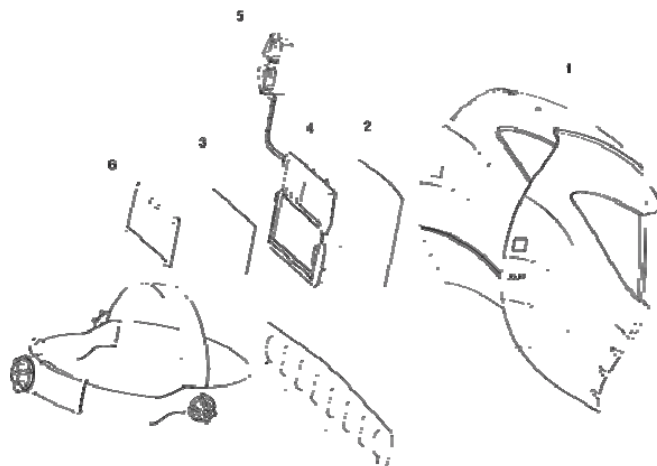

www.esab.com



COMPANY WITH
MANAGEMENT SYSTEM
CERTIFIED BY DNV
= ISO 9001 =
= ISO 14001 =
= OHSAS 18001 =